

Jabsco and Rule

COVERING THE WATERFRONT WORLDWIDE

Bilge Pumps, Waste Systems, Water Pressure Systems, Washdown Pumps,
Searchlights, Blowers, General Purpose Pumps

xylem
Let's Solve Water

MECTRA SYNERGY (M) SDN BHD

B-G-31 MENARA PRIMA, JALAN PJU 1/39 DATARAN PRIMA, 47301 PETALING JAYA, SELANGOR
TEL : +603 7886 1732 | EMAIL : sales@mectra.com.my | WEBSITE : www.mectra.com.my

Jabsco and Rule, covering the waterfront worldwide

Reliability. Engineered solutions. Fluid management science. These terms collectively describe the brands of Jabsco and Rule. They represent a legacy of marine innovation that spans almost 90 years, and account for millions of quality marine products sold and used around the globe.

Our history of marine leadership is a result of our dedication to continual development, which is reflected in the fact that our products are specified by the world's best-known boat builders and marine engine manufacturers. Collectively, we boast many industry firsts, including flexible impeller pump technology and oscillating diaphragm pumps.

The first Jabsco pump was designed in California in the 1930s. It introduced the flexible impeller, which is now used in cooling pumps on all small and medium sized marine engines. Today, Jabsco is the leading supplier of fresh water pumps, waste systems and general purpose pumps for marine use, supplying all boat builders worldwide with our products.

Rule submersible bilge pumps have a 50-year history of innovation and quality, and are trusted to keep boats dry and safe in the most arduous conditions. More innovations have come from Rule than any other manufacturer, and we're proud to have the broadest range of bilge pumps available today.

We have a global network of more than 500 distribution partners in 86 countries. So, when choosing your technology provider, select a partner who truly covers the waterfront - worldwide.

Discover more at marine.xylen.com, and catch our helpful Jabscotech product maintenance videos there or on YouTube.



Navigate to a world of online resources for boat owners



Learn more about quality Rule and Jabsco products for your boat, from stem to stern, at the Xylem Marine website:

marine.xylem.com

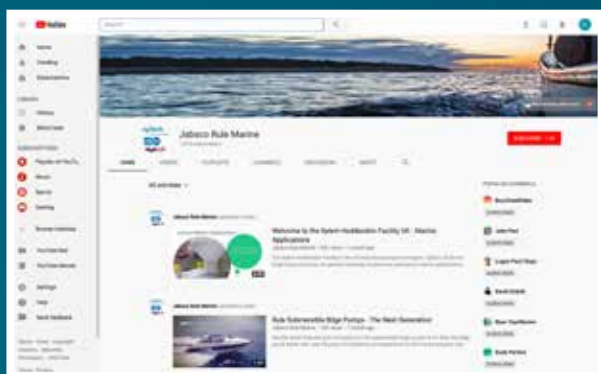

Find helpful how-to videos, product demonstrations and more at the Jabsco Rule Marine YouTube channel:

youtube.com/user/JabscoMarine



Get current product data sheets and a variety of do-it-yourself videos from the Jabsco Technical Help website:

marine.xylem.com/video-library

LET'S SHOW THE **BILGE** WHO'S BOSS

900 GPH LOW PROFILE BILGE PUMP

Designed to bring pumping power to tight spaces, Rule's LoPro Bilge Pump can move a mighty 900 gallons per hour.

- Fits into hard-to-reach places
- Fully automatic—three settings available—high, low, fully automatic
- Threaded discharge ports with multiple fittings available
- Includes check valves



RULE MATE SERIES

Thanks to advanced water-sensing technology, the Rule Mate Series bilge pumps move water automatically and efficiently.

- Robust pump and water-sensing switch in one
- No cycling—turns on only when water reaches 2¾"
- Threaded discharge ports allow for easier installation

STANDARD BILGE PUMPS

Rule's Standard Series Bilge Pump has the longest life and highest pumping power in the industry, making it the world leader.

- Leading bilge pump in the world
- Simple design, no frills
- Capacity ranges from 360 to 4000 gallons per hour



ELECTRONIC AUTOMATIC PUMPS

The compact Electronic Automatic Pump checks the water level every few minutes, making a float switch unnecessary.

- Compact automatic pump—no float switch required
- Pumps sense for water every 2½ minutes
- Ideal for tight spaces and trailer boat applications



01 Rule Bilge Pumping Systems

NEW Rule Bilge Pumps



Rule is the world's leading brand for submersible bilge pumps, drawing on 50 years of experience. We are constantly developing new and better solutions to help keep your bilge dry. Our new small bilge pump range provides the ultimate pumping performance, now more efficiently than ever, delivering full rated flow at just 12 volts instead of 13.6.

- Higher Flow - The optimized impeller provides greater flow at the same amperage.
- Built-In Thermal Cut-Off (TCO) - It provides added protection for the pump and vessel.
- Backflow Prevention - The non-return prevents water left in the discharge from running back, keeping bilges dryer and cleaner.
- Air Vents - Built into the body, they help prevent air locking in challenging plumbing installations.
- Ports - Pumps offer a choice of straight or 90 degree ports to suit your installation.

NOMINAL GPH/LPH	MODEL NO.	VOLTS (DC)
360 (1363)	24DA	12
500 (1893)	25DA	12
500 (1893)	25DA-24	24
800 (3028)	20DA	12
800 (3028)	20DA-24	24
1100 (4164)	27DA	12
1100 (4164)	27DA-24	24

Rule Higher Capacity Bilge Pumps



Our range of higher capacity standard bilge pumps are usually operated via a float switch or another level-sensing device, and give outputs from 1500 GPH (5678 LPH) to 4000 GPH (15141 LPH). Our Gold series pumps come with five-year warranties.

NOMINAL GPH/LPH	MODEL NO.	VOLTS (DC)
1500 (5678)	02	12
1500 (5678)	02-6	12
1500 (5678)	04 (Gold)	12
1500 (5678)	03	24
2000 (7570)	10	12
2000 (7570)	09 (Gold)	12
2000 (7570)	12	24
3700 (14006)	14A	12
3700 (14006)	13A (Gold)	12
3700 (14006)	16A	24
4000 (15141)	56D	12
4000 (15141)	56D-24	24

Rule Float Switches



A standard bilge pump operates by a control switch that senses water and activates the pump. Rule's Float Switches offer outstanding performance. We use extra-large float chambers for increased buoyancy and detachable mounting bases that make them easier to install and remove for cleaning and inspection. All models are suitable for pumps that draw up to 20 amps, except the Model 35 Rule-A-Matic, which is suitable up to 14 amps.

Rule also produces the ECO-switch, which operates when rising bilge water levels increase air pressure. All switching gear is located outside of the bilge in a sealed, compact unit.

MODEL NO.	MODEL NAME	VOLTS (DC)
35A	Rule-A-Matic	12-24
35FA	Rule-A-Matic with in-line fuser holder	12-24
37A	Super Switch	12-24-32
37FA	Super Switch with in-line fuser holder	12-24-32
40A	Rule-A-Matic Plus with shield	12-24-32
40FA	Rule-A-Matic Plus with shield and in-line fuser holder	12-24-32
39	ECO-switch	12
39-24	ECO-switch	24

Rule Automatic Bilge Pumps



Our electronic sensing series bilge pumps turn the pump impeller every 2-1/2 minutes for approximately one second. If water is present, the pump will sense resistance and will continue to run until all water is removed. This system is a compact way of constantly sensing for water presence.

NOMINAL GPH/LPH	MODEL NO.	VOLTS (DC)
500 (1893)	25SA-6	12
500 (1893)	25SA-24	24
800 (3028)	20SA	12
1100 (4164)	27SA	12
1100 (4164)	27SA-24	24
1500 (5678)	51S	12
2000 (7571)	53S	12
3700 (14006)	55S	12
4000 (15141)	56S	12

Rule LoPro Bilge Pumps



LP900S - Automatic



LP900D - Standard

Our latest automatic pump design, the LoPro allows for pumping out of tight spaces and shallower bilges. The LP900S model uses a unique double system for sensing water, to ensure that the pump only ever operates when water is present, and switches off efficiently when it's not. If water is sensed, the pump will spin the impeller as a double check. If water is confirmed, the pump will run to empty the bilges. A second sensing mode is also available, which sets the pump to run at either 1.3" (3.25cm) or 2" (5cm). The pump body rotates to allow discharge in any direction. A selection of straight and 90 degree ports, and a non-return valve for use with straight ports, are supplied. The LP900D model has no sensors and can be operated via a manual switch or a float switch.

NOMINAL GPH/LPH	MODEL NO.	VOLTS (DC)
900 (3407)	LP900S	12
900 (3407)	LP900D	12

Rule-Mate Automated Bilge Pumps



RM750A



RM1100A



RM1500A



RM2000A

When water enters the bilge and reaches 2-3/4" (7cm), a sensor turns on the pump. After the water is pumped out, another sensor shuts off the pump. The Rule-Mate II series is available in 500, 750, 1100, 1500 and 2000 GPH models. These pumps feature an all-in-one pump and switch, which means no float switch is required. They also include a snap-off strainer for easy cleaning, anti-fouling impeller, and limited three-year warranty. Rule-Mate pumps have been chosen by many of the world's leading boat builders as a compact and reliable bilge system.

NOMINAL GPH/LPH	MODEL NO.	VOLTS (DC)
500 (1893)	RM500A	12
500 (1893)	RM500A-24	24
750 (2839)	RM750A	12
750 (2839)	RM740A-24	24
1100 (4164)	RM1100A	12
1100 (4164)	RM1100A-24	24
1500 (5678)	RM1500A	12
2000 (7571)	RM2000A	12
2000 (7571)	RM2000A-24	24

02 Jabsco Self-Priming Bilge Pumps

Jabsco 50880 Series Bilge Pumps



This single diaphragm pump is ideal for emptying the shallowest of bilges. The 50880 is a reliable, compact pump with a 4.2 GPM (16 LPM) output. Self-priming to 10' (3m), it's capable of extensive dry running. The 50880's filterless design makes it virtually impossible to block and simplifies maintenance. It features multi-position ports, which help simplify installation.

MODEL NO.	VOLTS (DC)
50880-1000	12
50880-1100	24

Jabsco Maxi Puppy 3000 Series



12 GPM (45 LPM)

A high-pressure and high-flow pump for bilge pumping, the Maxi Puppy 3000 is self-priming up to 8' (2.4m), and offers an output of 720 GPH (2725 LPH). It's built to last with a bronze pump head and an oil-resistant nitrile impeller.

MODEL NO.	VOLTS (DC)
23610-3003	12
23610-3103	24



03 Jabsco Manual Bilge Pumps

Jabsco Amazon Warrior



Designed for larger craft, the Warrior is capable of an amazing output of 35 GPM (132 LPM). Its big, 18" (45cm) handle makes pumping easy, whether mounted on or through the deck. Built from a robust alloy, it features twin diaphragms for added safety, and includes 1-1/2" (38mm) hose ports.

MODEL NO.	DESCRIPTION
29280-0000	Warrior heavy-duty hand pump
29279-0000	Optional through-deck kit
29289-0000	Under-deck bracket (required for installation with 29279-0000)

Jabsco Amazon Universal



Jabsco's most versatile manual bilge pump, the Universal can be mounted on or through the bulkhead or deck. Designed for larger and medium sized boats with a flow rate of up to 25 GPM (95 LPM), it's equally good at emptying holding tanks and easily handles solids.

MODEL NO.	DESCRIPTION
29270-0000	Universal 1-1/2" (38mm) hose
29279-0000	Optional through-deck kit

Jabsco Amazon Thrudeck



The Thrudeck's design offers unlimited options for port direction, and allows easy access to the pump chamber and valves. It comes with a choice of a 1" (25mm) port that provides a 13 GPM (50 LPM) output, or a 1-1/2" (38mm) port that provides an output up to 20 GPM (75 LPM).

MODEL NO.	DESCRIPTION
29250-0000	Universal pump with detachable handle with 1" ports
29250-0010	Universal pump with detachable handle with 1-1/2" ports

Jabsco Amazon Bulkhead



The most compact pump in the Amazon range, the Bulkhead is designed specifically for smaller boats, yet still provides a powerful output of 12 GPM (45 LPM). Suitable for mounting on a bulkhead or deck, its multi-position ports and body configuration offer an amazing 96 assembly variations. It features a 1" (25mm) discharge.

MODEL NO.	DESCRIPTION
29240-0000	Bulkhead pump with detachable handle

04 Bilge Pumping Accessories

Jabsco Bilge Pumpgard™ Strainers



The Pumpgard™ protects electric diaphragm bilge pumps from particles in the water. Its transparent housing allows instant inspection and quick, in-place cleaning.

MODEL NO.	DESCRIPTION
46200-0000	3/4" (19mm) ID hose
46200-0010	3/4" (19mm) ID hose x plug-in 90°

Jabsco Amazon Bilge Strainers



Jabsco Amazon Bilge Strainers keep bilge debris from blocking the pump. Non-return valves prevent the backflow of water into the bilge. Outlet ports can be positioned from horizontal to vertical. Strainers are available for 3/4", 1" and 1-1/2" (19mm, 25mm and 38mm) hoses.

MODEL NO.	DESCRIPTION
29290-1020	3/4" (19mm) hose
29290-1000	1" (25mm) hose
29290-1010	1-1/2" (38mm) hose

Jabsco Non-Return Valves



Jabsco Non-Return Valves help priming, and prevent backflow of water into the bilge. Three sizes are available, for 3/4", 1" and 1-1/2" (19mm, 25mm and 38mm) hoses.

MODEL NO.	DESCRIPTION
29295-1011	3/4" (19mm) hose
29295-1000	1" (25mm) hose
29295-1010	1-1/2" (38mm) hose

Rule Panel Switches



45



41, 42



43, 44



49

These panels control pumps equipped with an automatic float switch or a float switch/pump combo. Models 41 through 45 have three switch positions: automatic, off and manual. Model 49 is a simple, classic-looking on/off switch. Models 41, 42, 45, and 49 are enamel-coated stainless steel. Models 43 and 44 are made from an impact-resistant, UV-stabilized plastic.

MODEL NO.	DESCRIPTION	VOLTS (DC)	MAX AMPS (DC)
41	3-way panel switch - lighted	12	20
42	3-way panel switch - lighted	24-32	10 (24V), 6.5 (32V)
45	3-way panel switch	12-24-32	20 (12V), 10 (24V), 6.5 (32V)
43	3-way rocker panel switch - lighted	12	20
44	3-way rocker panel switch - lighted	24	10
49	2-way panel switch	12-24-32	20 (12V), 10 (24V), 6.5 (32V)



05 Jabsco Water Pressure Systems

Jabsco PAR-Max Series Water Pressure Pumps are simple, quiet, easy to maintain, and provide hot or cold water at the turn of a tap. They're also versatile enough to produce a full flow or a trickle, according to need. These diaphragm pumps provide smooth flow with good pressure. Simply choose a model suitable for the number of outlets on your boat.

FLOW RATES ARE GIVEN FOR EACH PUMP, WITH AN INDICATION OF THE NUMBER OF OUTLETS IT CAN SERVE.

1 (hot or cold) FAUCET = 1 outlet

1 (hot and cold) MIXER = 2 outlets

Jabsco PAR-Max 1 Water Pressure Pumps



Our smallest pump, the PAR-Max 1 is designed for smaller day boats. It's available with or without an elegant faucet.

MODEL NAME	MODEL NO.	OUTLETS	VOLTS (DC)	PRESSURE CUTOFF
PAR-Max 1	42630-2992-P	1-2	12	35 psi (2.4 bar)
PAR-Max 1	42630-2994-P	1-2	24	35 psi (2.4 bar)
PAR-Max 1 with faucet*	42630-3992-P	1-2	12	35 psi (2.4 bar)
PAR-Max 1 with faucet*	42630-3994-P	1-2	24	35 psi (2.4 bar)

*Kit includes pump, faucet and 20' (6.1m) of 1/4" (6.3mm) tubing.

Jabsco PAR-Max 1.9 Water Pressure Pumps



The PAR-Max 1.9 is suitable for smaller boats with one or two outlets, producing 1.9 GPM (7.2 LPM). It's supplied with a built-in pulsation-dampening bypass to reduce cycling and noise; this provides the option of omitting an accumulator tank on simple installations.

MODEL NO.	OUTLETS	VOLTS (DC)	PRESSURE CUTOFF
31295-0092	1-2	12	25 psi (1.7 bar)
31295-0094	1-2	24	25 psi (1.7 bar)

Jabsco PAR-Max 2.9 Water Pressure Pumps



The PAR-Max 2.9 is suitable for one to three outlets, offering 2.9 GPM (10.9 LPM). It has the same bypass feature as the PAR-Max 1.9, allowing it to be used without an accumulator tank if desired.

MODEL NO.	OUTLETS	VOLTS (DC)	PRESSURE CUT OFF
31395-0092	1-3	12	25 psi (1.7 bar)
31395-0094	1-3	24	25 psi (1.7 bar)

Jabsco PAR-Max 3.5 Water Pressure Pumps



The PAR-Max 3.5 pump produces 3.5 GPM (13.2 LPM). It's suitable for complex installations on larger boats with up to four outlets, and has a heavier-duty motor for longer life.

MODEL NO.	OUTLETS	VOLTS (DC)	PRESSURE CUTOFF
32600-0092	1-4	12	40 psi (2.8 bar)
32600-0094	1-4	24	40 psi (2.8 bar)
32600-0292	1-4	12	25 psi (1.7 bar)
32600-0294	1-4	24	25 psi (1.7 bar)

Jabsco PAR-Max 4 Water Pressure Pumps



The large PAR-Max 4 has a pulsation-free, four chamber diaphragm design, and flow rates of up to 4.5 GPM (17 LPM) for up to five outlets.

MODEL NO.	OUTLETS	VOLTS (DC)	PRESSURE CUTOFF
31620-0092	1-5	12	40 psi (2.8 bar)
31620-0094	1-5	24	40 psi (2.8 bar)
31620-0292	1-5	12	25 psi (1.7 bar)
31620-0294	1-5	24	25 psi (1.7 bar)

Jabsco Water Pressure Regulators



44412-1045



44412-2045



44411-0045

This device protects your boat's water system by limiting the inlet pressure to 45 psi (3.1 bar). It's available in two styles. The permanently installed flush mount model has a unique swivel elbow output. The compact in-line model is only 3" (77mm) long and has a removable strainer to protect the plumbing. Both are manufactured using food-grade materials and incorporate GHT fittings for potable garden hose connections.

MODEL NO.	DESCRIPTION
44411-0045	In-line, white, 3/4" (19mm) GHT male outlet, strainer not included
44412-1045	Flush, white, 1/2" (13mm) female quad port, strainer included
44412-2045	Flush, chrome, 1/2" (13mm) female quad port, strainer included

Jabsco PAR Plus Water System Pumps



Our latest design, the PAR Plus series is available with three flow rates: from 4, 5 and 6 GPM (15, 19 and 23 LPM). It was designed with mid-sized to larger boats in mind. It provides a smooth flow, quieter running, and a longer life due to its sealed switch design and co-molded diaphragm, which eliminate leak paths.

4 GPM (15 LPM) WATER PRESSURE SYSTEM PUMPS

MODEL NO.	OUTLETS	VOLTS (DC)	PRESSURE CUTOFF
82400-0092	1-4	12	60 psi (4.1 bar)
82400-0094	1-4	24	60 psi (4.1 bar)
82400-0292	1-4	12	40 psi (2.8 bar)
82400-0294	1-4	24	40 psi (2.8 bar)
82400-0392	1-4	12	25 psi (1.7 bar)
82400-0394	1-4	24	25 psi (1.7 bar)

5 GPM (19 LPM) WATER PRESSURE SYSTEM PUMPS

MODEL NO.	OUTLETS	VOLTS (DC)	PRESSURE CUTOFF
82500-0092	1-5	12	60 psi (4.1 bar)
82500-0094	1-5	24	60 psi (4.1 bar)
82500-0292	1-5	12	40 psi (2.8 bar)
82500-0294	1-5	24	40 psi (2.8 bar)
82500-0392	1-5	12	25 psi (1.7 bar)
82500-0394	1-5	24	25 psi (1.7 bar)

6 GPM (23 LPM) WATER PRESSURE SYSTEM PUMPS

MODEL NO.	OUTLETS	VOLTS (DC)	PRESSURE CUTOFF
82600-0092	1-6	12	60 psi (4.1 bar)
82600-0094	1-6	24	60 psi (4.1 bar)
82600-0292	1-6	12	40 psi (2.8 bar)
82600-0294	1-6	24	40 psi (2.8 bar)
82600-0392	1-6	12	25 psi (1.7 bar)
82600-0394	1-6	24	25 psi (1.7 bar)



06 Jabsco Variable Speed Drive Water & Stack Pressure Systems

Jabsco V-Flo 5.0 Constant Flow Water Pressure Pump



This variable flow, constant water pressure pump features technology to make your on-board water experience the same as you would expect on land. Capable of a flow rate up to 5.0 GPM (19 LPM), V-Flo is powered by a variable speed drive that delivers constant, consistent water pressure on demand. This enables pump startup and shut-off to be gradual, meaning no water hammer to shock your pipes or ears. It also reduces power consumption, making the motor super quiet at normal demand levels. It's revolutionary, providing the sophisticated performance that boat owners increasingly demand.

MODEL NO.	OUTLETS	VOLTS (DC)	PRESSURE CUTOFF
42755-0092	1-5	12	40 psi (2.8 bar)
42755-0094	1-5	24	40 psi (2.8 bar)
42755-0392	1-5	12	25 psi (1.7 bar)
42755-0394	1-5	24	25 psi (1.7 bar)

Jabsco Single and Double Stack Water Systems



5.8 GPM Model



4.8 GPM Model

Each of these fully assembled, easy-to-install water pressure systems uses either single or double PAR-Max 4 pumps, a strainer and a pre-pressurized accumulator tank. That means all the system connection work is done for you in one neat and easily accessible package. The Single Stack provides flow rates up to 4.8 GPM (18 LPM). There are two Double Stack Systems that provide variable flow rates up to 5.8 GPM (22 LPM) or 9 GPM (34 LPM). In heavy-demand situations on larger boats, the twin pump systems provide added security; should one pump fail, the second will continue to operate.

MODEL	MODEL NO.	OUTLETS	VOLTS (DC)	PRESSURE CUTOFF
Single Stack System 4.8	52520-1000	1-4	12	40 psi (2.8 bar)
Double Stack System 5.8	52530-3000	1-5	12	40 psi (2.8 bar)
Double Stack System 5.8	52530-3100	1-5	24	40 psi (2.8 bar)
Double Stack System 9	52530-1000	1-7	12	40 psi (2.8 bar)
Double Stack System 9	52530-1100	1-7	24	40 psi (2.8 bar)

07 Jabsco Water Pressure System Accessories

Jabsco Pressurized Accumulator Tanks



30573-0003



30573-0000



18810-0000 (US)



23240-2000 (EU)

Available in 21 ounce (0.5 liter), 1 quart (1 liter) and 2 gallon (8 liter) sizes, each Jabsco Accumulator Tank holds a reservoir of air and water that acts as a cushion, smoothing the water flow and keeping the system quiet. This allows the pump to reduce the on/off cycle, and offers better control of the hot and cold water pressure balance.

MODEL NO.	CAPACITY	MAX. PRESSURE
30573-0003	21 oz (0.5L)	125 psi (8.6 bar)
30573-0000	1 qt (1L)	125 psi (8.6 bar)
18810-0000 (US)	1.8 gal (6.8L)	75 psi (5.2 bar)
23240-2000 (EU)	2 gal (8L)	140 psi (10 bar)

Jabsco Water System Pumpgard™ Strainers



46400-0014



46400-0010



46400-0012



46400-0030



46400-0004



46400-0000



46400-0003

These compact pre-filters prevent particles from jamming valves and causing pump breakdowns. Each one features a screw-off, transparent housing for easy inspection and quick, in-place cleaning.

MODEL NO.	DESCRIPTION
46400-0000	3/4" (19mm) hose barb inlet, 3/4" (19mm) hose barb outlet
46400-0002	1/2" (13mm) hose barb inlet, 1/2" (13mm) hose barb outlet
46400-0003	3/8" (10mm) hose barb inlet, 3/8" (10mm) hose barb outlet
46400-0004	1/2" (13mm) QEST (threaded) port male inlet, 1/2" (13mm) QEST port male outlet
46400-0010	90° strainer, 3/4" (19mm) hose barb inlet, quad port male outlet
46400-0012	90° strainer, 1/2" (13mm) hose barb inlet, quad port male outlet
46400-0014	90° strainer, 1/2" (13mm) QEST (threaded) port female inlet, quad port male outlet
46400-0030	Quad port female inlet, quad port male outlet, compact version
46400-0375	3/8" (10mm) NPT female port inlet, 3/8" (10mm) NPT female port outlet
46400-0701	Large in-line strainer (6 GPM/23 LPM), quad port female inlet, quad port female outlet
46400-0711	Large 90° strainer (6 GPM/23 LPM), quad port female inlet, quad port male outlet
46400-0712	Large 90° strainer (6 GPM/23 LPM), 1/2" (13mm) hose barb inlet, quad port male outlet
46400-9500	90° strainer, quad port female inlet, quad port male outlet

08 Jabsco Toilet Systems

Jabsco is the world's largest manufacturer of small craft marine toilets, so we have a fair amount of experience in waste system design and installation.

Our latest manual toilets are easy to service, simple to use, and offer terrific value for the money. Two bowl sizes are available; all but only the smallest of head compartments have sufficient room for the regular bowl. Manual toilets can be upgraded to full electric operation using one of our conversion kits, or simply by installing the Lite Flush toilet, which is designed to fit existing mounting bolts and inlet and outlet pipework.

Our range of electric toilets go from simple designs with narrow bases, to sophisticated Deluxe Flush models with one-touch controls, near-silent operation, and short or long flushes. Discharging waste overboard is illegal or unacceptable in many areas, so we also supply a range of holding tanks and tank emptying systems that make installation simple.

All models are supplied with a standard close seat and lid, unless the optional soft close seat part number is specified.

Jabsco Twist 'n' Lock Manual Toilets



The world's most popular marine toilet, Jabsco's sturdy manual model ensures protection against waste backflow with an easy turn of the Twist 'n' Lock pump handle. Reversible pump mounting allows left-handed operation. Available with a regular or compact bowl, and designed to be easy to install, use and keep clean, this super reliable unit is the boat builder's toilet of choice.

MODEL NO.	DESCRIPTION
29090-5000	Compact bowl
29120-5000	Regular bowl
29120-5100	Regular bowl (soft close seat)

Jabsco Lite Flush Electric Toilets – Upgrade your manual toilet to electric



Designed to instantly retrofit your existing Jabsco Manual Toilet, this compact and lightweight unit will give your bathroom quiet and efficient flushing performance and a modern, stylish look. Featuring low water usage and low power consumption, the Lite Flush Toilet is available with either a foot switch (left or right fitted) or a wall-mounted control panel. Lite Flush uses all your existing pipework and mounting bolts; all you need to add is power.

MODEL NO.	DESCRIPTION
58500-0012	Foot switch, 12V
58500-0024	Foot switch, 24V
58500-1012	Control panel, 12V
58500-1024	Control panel, 24V

09 Jabsco Electric Conversion Kits

Jabsco 29200 Electric Conversion Kit for Manual Toilets



This simple-to-install kit replaces the pump on a Jabsco Manual Toilet with an electric pump, using the same hose. It comes ready to fit directly in place of the existing pump. Its spring return knob has two positions, one for bowl emptying and the other for emptying and flushing.

MODEL NO.	VOLTS (DC)
29200-0120	12
29200-0240	24

Jabsco 37010 Conversion Kit



This conversion kit upgrades a manual toilet to a Jabsco 37010 Electric Toilet using the existing bowl. It's designed to fit a Jabsco Manual Toilet, as well as many competitors' models.

MODEL NO.	DESCRIPTION
37010-0092	Conversion kit, 12V
37010-0097	Conversion kit, 24V



a xylem brand



ANSWER
NATURE'S CALL
**WHILE
AT SEA.**

From manual marine toilets to luxury models, everyone trusts Jabsco.

xylem
Let's Solve Water

10 Jabsco Electric Toilets

Jabsco Quiet Flush Electric Toilets



The Quiet Flush was designed to reduce noise levels when flushing. A three-way switch allows operation of the flush pump, the discharge pump or both, allowing the water level to be adjusted for user comfort. These toilets are available in regular or compact bowl sizes, and in two models: one has an intake pump for external water flushing, while the other has a special solenoid valve and siphon breaker to prevent contamination if the system is connected to a drinking water pressure pump.

MODEL NO.	DESCRIPTION
37045-3092	Compact bowl with solenoid valve, 12V
37045-3094	Compact bowl with solenoid valve, 24V
37045-4092	Regular bowl with solenoid valve, 12V (37045-4192 soft close seat)
37045-4094	Regular bowl with solenoid valve, 24V (37045-4194 soft close seat)
37245-3092	Compact bowl with intake pump, 12V
37245-3094	Compact bowl with intake pump, 24V
37245-4092	Regular bowl with intake pump, 12V (37245-4192 soft close seat)
37245-4094	Regular bowl with intake pump, 24V (37245-4194 soft close seat)

Jabsco 37010 Series Economy Electric Toilets



This traditional-style electric toilet is self-priming up to 4' (1.2m), and can discharge through a maximum vertical head of 4' (1.2m). It comes complete with a molded splashguard and a simple switch. 37010 Series Toilets are available with compact and regular size bowls.

MODEL NO.	DESCRIPTION
37010-3092	Compact bowl, 12V
37010-3094	Compact bowl, 24V
37010-4092	Regular bowl, 12V (37010-4192 soft close seat)
37010-4094	Regular bowl, 24V (37010-4194 soft close seat)

Jabsco Deluxe Flush Electric Toilets



This is real at-home luxury. The stylish and comfortable design of the Deluxe Flush Toilet conceals the flush pump, wiring and plumbing in wraparound ceramic, and all models feature a full-size seat. Two bowl heights (14" and 17") are available in either straight or slant back. The Deluxe Flush uses as little as 1 quart (1 liter) of water per flush; its one-touch control pad provides short or long flush options and the ability to adjust the bowl's water level. It also offers the choice between flushing with fresh water from the boat's system (a solenoid valve), or sea, river or lake water (an intake pump). Using the boat's water system eliminates the potential for dirty external water to enter the toilet bowl during flushing.

MODEL NO.	DESCRIPTION
58060-1012	14" (36cm) slanted-back bowl with solenoid valve, 12V
58060-1024	14" (36cm) slanted-back bowl with solenoid valve, 24V
58260-1012	14" (36cm) slanted-back bowl with intake pump, 12V
58260-1024	14" (36cm) slanted-back bowl with intake pump, 24V
58080-1012	14" (36cm) straight-back bowl with solenoid valve, 12V
58080-1024	14" (36cm) straight-back bowl with solenoid valve, 24V
58280-1012	14" (36cm) straight-back bowl with intake pump, 12V
58280-1024	14" (36cm) straight-back bowl with intake pump, 24V
58020-1012	17" (44cm) slanted-back bowl with solenoid valve, 12V
58020-1024	17" (44cm) slanted-back bowl with solenoid valve, 24V
58220-1012	17" (44cm) slanted-back bowl with intake pump, 12V
58220-1024	17" (44cm) slanted-back bowl with intake pump, 24V
58040-2012	17" (44cm) vertical-back bowl with solenoid valve, 12V (58040-3012 soft close seat)
58040-2024	17" (44cm) vertical-back bowl with solenoid valve, 24V (58040-3024 soft close seat)
58240-2012	17" (44cm) vertical-back bowl with rinse pump, 12V (58240-3012 soft close seat)
58240-2024	17" (44cm) vertical-back bowl with rinse pump, 24V (58240-3024 soft close seat)



11 Jabsco Toilet System Accessories

Jabsco Run-Dry Macerator Waste Pumps



This waste tank-emptying macerator pump grinds solids into small particles that easily pass through the 1" (25mm) discharge port. The Jabsco Macerator is equipped with a protection device that eliminates accidental run dry.

MODEL NO.	VOLTS (DC)	DESCRIPTION
18590-2092	12	1-1/2" (38mm) hose barb and 1-1/2" (38mm) NPT intake
18590-2094	24	

Jabsco Diaphragm Waste Pump



This super quiet and compact pump has a straight-through waste path that easily passes solids in suspension, making it the ideal solution for emptying holding tanks. Self-priming up to 10' (3m) and capable of extensive dry running, it provides a 5 GPM (19 LPM) output.

MODEL NO.	VOLTS (DC)	DESCRIPTION
50890-1000	12	1-1/2" (38mm) hose barb intake and discharge
50890-1100	24	

Jabsco Waste Management System



This is an easy-to-install, all-inclusive system consisting of a compact polyethylene holding tank and an integral Run-Dry Macerator Pump. It has a touchpad control panel to monitor waste levels; when required, the user can activate the macerator pump to evacuate waste.

MODEL NO.	VOLTS (DC)
38110-0092	12

Jabsco Toilet Pumpgard™



The Pumpgard™ inlet strainer guards manual or electric toilets from pump malfunctions caused by debris. It has connections for a 3/4" (19mm) hose.

MODEL NO.	DESCRIPTION
46400-0000	Toilet Pumpgard

Jabsco Solenoid Valves for 37010 Electric Toilet



This valve is essential for 37010 Electric Toilets fitted with a vented loop on the inlet pipework, which can restrict priming and flow. The solenoid valve is controlled by the toilet operation switch, providing full performance.

MODEL NO.	DESCRIPTION
37068-2000	Solenoid valve for 37010 Electric Toilets
(For use with: 29015-0000 3/4" (19mm) Vented Loop)	

Jabsco Vented Loops



Vented loops guard against the danger of water siphoning over pipework loops in below-the-waterline installations of toilets and bilge pumps. They should be installed in both inlet and outlet pipework.

MODEL NO.	DESCRIPTION
29015-0000	3/4" (19mm) model
29015-0020	1" (25mm) model
29015-0010	1-1/2" (38mm) model

Jabsco Y-Valve



This robust valve allows waste to be pumped directly overboard or into a holding tank. Rotating discharge ports simplify installation. Both 1" (25mm) and 1-1/2" (38mm) inlet ports are included. The Y-Valve can be operated through a bulkhead using the optional shaft extension.

MODEL NO.	DESCRIPTION
45490-1000	Y-Valve
45500-1000	Extension for through-bulkhead operation

12 General Purpose Pumps

Rule Slimline Series Submersible Pumps



This family of compact pumps and portable pump kits is designed for a wide variety of uses, both onboard and ashore. Each pump is a combination of a submersible and an in-line pump, and can deliver hot or cold fresh water, seawater, antifreeze and even diesel. Slimline Pumps can be used for deck showers, general washdown, water or diesel transfer, engine winterizing and more.

MODEL NO.	DESCRIPTION
iL200	12V DC, pump
iL200K	12V DC, pump kit complete with hose, nozzle and battery clips
iL200P	12V DC, pump
iL200P-24	24V DC, pump
iL280P	12V DC, pump complete with battery clips
iL280P-24	24V DC, pump complete with battery clips
iL280PK	12V DC, pump kit complete with hose, nozzle and battery clips
iL280PK-24	24V DC, pump kit complete with hose, nozzle and battery clips
iL500P	12V DC, pump complete with battery clips
iL500P-24	24V DC, pump complete with battery clips
iL500PK	12V DC, pump kit complete with hose, nozzle and battery clips
iL500PK-24	24V DC, pump kit complete with hose, nozzle and battery clips

Rule Utility 110 Volt Series Submersible Pumps



This pump's versatile design makes it ideal for removing accumulated water from basements, garages, stairwells, utility rooms, backyards, sumps and other hard-to-reach spaces. It features a powerful 1800 GPH motor that only consumes 100 watts while delivering up to 1800 gallons per hour. Automatic and non-automatic versions are available, both utilizing standard 110-volt AC current.

MODEL NO.	DESCRIPTION
A53S	Automatic, 1800 GPH (6814 LPH), 8' (2.4m) cord*
A53S-24	Automatic, 1800 GPH (6814 LPH), 24' (7.3m) cord*
A53D	Standard 1800 GPH (6814 LPH), 8' (2.4m) cord*

*Garden hose and rigid pipe adapters included.

Jabsco Commercial Duty Water Puppy



9 GPM (34 LPM)

This workhorse is designed for general transfer duty. Self-priming up to 8' (2.4m), it has an output of 540 GPH (2044 LPH).

MODEL NO.	VOLTS (DC)
18670-0123	12 (not for sale in Europe)
18670-0943	24 (not for sale in Europe)
23680-4003	12 (European model)
23680-4103	24 (European model)

13 Jabsco Washdown Pumps & Kits

Jabsco PAR-Max 3 and 4 Washdown Pumps

Included



Designed for cleaning decks, cockpits, and anchors on yachts in a range of sizes, this full line of pumps provides 3 GPM (11 LPM) and up to 50 psi (3.5 bar) pressure. That's sufficient power to blast decks and anchor lines clean. Suitable for sea or fresh water, each one comes with an intake strainer, a spray nozzle and quick-connect 3/4" hose barb fittings. Some models are also supplied with a length of hose coil.

PAR-MAX 3.0 GPM (11 LPM)

MODEL NO.	DESCRIPTION
32305-0092	12V, supplied with strainer and nozzle, US only
32305-0094	24V, supplied with strainer and nozzle, US only
32305-0392	12V, supplied with strainer and nozzle
32305-0394	24V, supplied with strainer and nozzle
32901-0092	12V, supplied with strainer, nozzle and 25' (7.6m) hose coil
32901-0094	24V, supplied with strainer, nozzle and 25' (7.6m) hose coil

PAR-MAX 4.0 GPM (15 LPM)

MODEL NO.	DESCRIPTION
32605-0092	12V, supplied with strainer and nozzle, US only
32605-0094	24V, supplied with strainer and nozzle, US only
32605-0392	12V, supplied with strainer and nozzle
32605-0394	24V, supplied with strainer and nozzle
32900-0092	12V, supplied with strainer, nozzle and 25' (7.6m) hose coil
32900-0094	24V, supplied with strainer, nozzle and 25' (7.6m) hose coil



Jabsco HotShot Series Washdown Pumps and Kits



These washdown pumps supply a massive 70 psi (4.8 bar) of pressure for ultra-effective deck and anchor cleaning, and offer three flow rates: 4 GPM (15 LPM), 5 GPM (19 LPM) and 6 GPM (23 LPM). All models are supplied with Pumpgard™ strainers and trigger nozzles. Some models are available with a 25' (7.6m) length of self-coiling hose. These models have sealed switches and co-molded diaphragms for up to 50 percent longer working life.

4.0 HOTSHOT SERIES: FLOW RATE UP TO 4.0 GPM (15 LPM)

MODEL NO.	DESCRIPTION
82405-0092	12V, supplied with strainer and nozzle
82405-0094	24V, supplied with strainer and nozzle
82904-0092	12V, supplied with strainer, nozzle and 25' (7.6m) hose coil
82904-0094	24V, supplied with strainer, nozzle and 25' (7.6m) hose coil

5.0 HOTSHOT SERIES: FLOW RATE UP TO 5.0 GPM (19 LPM)

MODEL NO.	DESCRIPTION
82505-0092	12V, supplied with strainer and nozzle
82505-0094	24V, supplied with strainer and nozzle
82905-0092	12V, supplied with strainer, nozzle and 25' (7.6m) hose coil
82905-0094	24V, supplied with strainer, nozzle and 25' (7.6m) hose coil

6.0 HOTSHOT SERIES: FLOW RATE UP TO 6.0 GPM (23 LPM)

MODEL NO.	DESCRIPTION
82605-0092	12V, supplied with strainer and nozzle
82605-0094	24V, supplied with strainer and nozzle
82906-0092	12V, supplied with strainer, nozzle and 25' (7.6m) hose coil
82906-0094	24V, supplied with strainer, nozzle and 25' (7.6m) hose coil

Jabsco Quick Connect Deck Nozzles for Washdown Systems



This quick-release, flush-fitting nozzle will quickly connect a Jabsco hose coil and trigger nozzle to the through-deck fitting of a pump and hose installed below decks. Connection and disconnection can be made under pressure, thanks to positive bayonet locks. Quick Connect Deck Nozzles are made of marine-grade stainless steel.

MODEL NO.	DESCRIPTION
31911-0000	Straight quick connector and hose connection 1/2" NPT to 3/4" garden hose thread (GHT) for US use
31911-0001	Angled quick connector and hose connection 1/2" NPT to 3/4" garden hose thread (GHT) for US use
31911-0007	Straight quick connector and hose connection 1/2" (13mm) BSP to 3/4" garden hose thread (GHT) for EU use

14 Jabsco & Rule General Purpose Pumps

Jabsco 50880 Sink and Shower Drain Pumps



A new generation single diaphragm pump, the 50880 makes installation simple, thanks to its compact size and multi-position ports. It has a 254 GPH (960 LPH) output, it's self-priming to 10' (3m), and it can handle extensive dry running. Its filterless design is virtually unblockable and makes maintenance easy.

MODEL NO.	VOLTS (DC)	DESCRIPTION
50880-1000	12	3/4" (19mm) and 1" (25mm) hose barb intake and discharge
50880-1100	24	

Rule Shower Drain Systems



This compact, full-capacity shower drain system provides either 800 GPH (3028 LPH) or 1100 GPH (4164 LPH) of output. Activated by a float switch, it turns on as the tank fills and shuts off when it's empty. It has three inlet ports that offer varying combinations for the inlet hose, as well as a quick-release tank lid and an easy-clean internal strainer.

MODEL NO.	DESCRIPTION	VOLTS (DC)
98B	800 GPH (3028 LPH) shower drain system	12
98B-24	800 GPH (3028 LPH) shower drain system	24
99B	1100 GPH (4164 LPH) shower drain system	12
99B-24	1100 GPH (4164 LPH) shower drain system	24

Jabsco Diesel Refueling Pumps



9 GPM (35 LPM)



13 GPM (50 LPM)



26 GPM (100 LPM)

These rugged Jabsco units range in pumping capacity from a reliable 9 GPM (35 LPM) to a mighty 26 GPM (100 LPM). All three are rated for continuous operation, and are widely used in the demanding off-road construction sector, so reliability is assured.

9 GPM (35 LPM) DIESEL REFUELING PUMP

MODEL NO.	VOLTS (DC)
23870-1200	12
23870-1300	24

13 GPM (50 LPM) DIESEL REFUELING PUMP

MODEL NO.	VOLTS (DC)
VR050-1022	12
VR050-1122	24

26 GPM (100 LPM) DIESEL REFUELING PUMP

MODEL NO.	VOLTS (DC)
VR100-1122	24

15 Oil Change Pumps & Systems

Jabsco Little Pal and Handy Boy Manual Utility Pumps

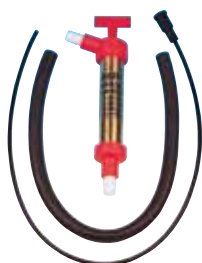

34060-0010
Little Pal



33799-0000
Handy Boy

These compact brass hand pumps are designed to drain oil from engines and gearboxes. The Little Pal produces up to 1 GPM (4 LPM) output, while the Handy Boy gives up to 1.5 GPM (6 LPM). Both come equipped with hoses, connectors, and dipstick probes for various requirements.

MODEL NO.	HOSE PORT	LENGTH
34060-0010	1/2" hose barb	10.25"
34060-0130	GHT inlet x 1/2" hose barb	10.25"
33799-0000	1/2" hose barb	12"
33760-0000	1/2" hose barb	17"
33745-0000	1" hose barb	22.5"

Jabsco Mini Puppy



1.4 GPM (5.3 LPM)

Designed for permanent, onboard installation, the Mini Puppy will empty oil sumps into a suitable container. With up to 1.4 GPM (5.3 LPM) output, it's self-priming up to 5' (1.5m), and it's simple to service.

MODEL NO.	VOLTS (DC)
23620-4003	12
23620-4103	24

Jabsco Oil Change Pump



3 GPM (11.3 LPM)

This powerful, stand-alone pump can service a typical V8 engine in just minutes. It's the same high-quality pump used in the Jabsco multi-engine Oil Changer System.

MODEL NO.	VOLTS (DC)
17830-0012	12
17830-0024	24

Jabsco Permanent Mount Oil Changer System



This system consists of a robust, self-priming flexible impeller pump mounted to an easy-to-install base, and coupled to a five-port manifold. Factory-fitted with three full-flow ball valves, it allows one system to perform oil changes on two engines and a generator.

MODEL NO.	VOLTS (DC)
17820-0012	12
17820-0024	24

16 Jabsco Oil Change Systems

Jabsco Porta-Quick



The ultimate answer to hassle-free oil changing, this robust reversible pump comes ready for use. It's mounted on a 3.5 gallon (13 liter) container and supplied with cables, battery clips and hoses. Operating the Porta-Quick one way empties the oil into the container; flipping the pump switch the other way empties the container into a suitable receptacle. It's self-priming up to 4' (1.2m).

MODEL NO.	VOLTS (DC)
17800-2000	12 (non CE)
17800-2024	24

Jabsco DIY Oil Changer



This simple unit performs quick and easy oil changes for the leisure boat owner.

MODEL NO.	VOLTS (DC)
17850-1012	12

Jabsco Flat Tank Oil Changer System



The 3.5 gallon (13 liter) flat tank design of this system makes for a clean and simple oil change on any boat. It allows trouble-free disposal, thanks to the stable, easy-to-carry design.

MODEL NO.	VOLTS (DC)
17860-2012	12

Jabsco Drill Pumps



These pumps provide versatile utility. They can transfer fluid almost anywhere that an electric drill with 1/4" to 3/8" chuck can be used.

MODEL NO.	DESCRIPTION
17250-0003	Pump (boxed) with two garden hose thread port adapters
17215-0000	Pump (poly bagged with header card) with garden hose port adapters and 1/4" x 40" probe plus 3' of 1/2" hose for changing oil through a dipstick tube

17 Jabsco Ballast Pumps

Jabsco Ballast Puppy



Without a doubt, this is the most popular wakeboard ballast pump in history. Its success is for good reason; the reversible design simplifies installation and reduces the number of components required. Its track record proves that it's a fast, efficient, reliable performer. With a flow rate of 9 GPM (34 LPM), it can quickly add up to 80 pounds (40 kgs) of water per minute to ballast tank systems. The Ballast Puppy is reversible, so it can both fill and empty ballast tanks. It's self-priming and therefore will not air lock.

MODEL NO.	DESCRIPTION
18220-1127	12V, includes reversing switch
18220-2127	12V, pump only

Jabsco Ballast King



This is the higher flow version of the Ballast Puppy. Featuring a larger motor, the Ballast King will pump up to 15 GPM (57 LPM), which will add up to 125 pounds of ballast water per minute. It's reversible, so it can both empty and fill ballast tanks. It's self-priming and the impeller is run dry.

MODEL NO.	DESCRIPTION
22610-9507	12V, includes reversing switch
22610-9007	12V, pump only



18 Jabsco Circulation Pumps

Jabsco Cyclone Centrifugal Pumps



This long-life, continuously rated centrifugal pump delivers high flows up to 29 GPM (110 LPM) with a maximum pressure of 8.7 psi (0.6 bar). The Low Pressure Cyclone is ideal for hot water circulation duties such as engine cooling and central heating systems.

MODEL NO.	DESCRIPTION
50840-0012	12V, 3/4" NPT connections
50840-0024	24V, 3/4" NPT connections
50840-2012	12V, 3/4" BSP connections
50840-2024	24V, 3/4" BSP connections

Jabsco High Pressure Cyclone Centrifugal Pumps



The High Pressure Cyclone is a long-life pump that delivers flows of up to 21 GPM (80 LPM) and pressures up to 17 psi (1.2 bar), making it ideal for general transfer and circulation duties for water and mild chemicals where more restrictions are present. It can be used in conjunction with trigger nozzles.

MODEL NO.	DESCRIPTION
50860-0012	12V, 3/4" NPT connections
50860-0024	24V, 3/4" NPT connections
50860-2012	12V, 3/4" BSP connections
50860-2024	24V, 3/4" BSP connections

Jabsco Magnetic Drive Circulation Pumps



59520



59510



59530

Small, compact, and specifically designed for circulation duties, this continuously rated pump provides trouble-free operation. Applications include hot water circulation and raw water cooling.

MODEL NO.	DESCRIPTION
59510-0012	12V, 3.3 GPM (12.5 LPM)
59520-0000	8-24V, up to 5.5 GPM (21 LPM)
59530-0000	8-24V, 5.5 GPM (21 LPM)

19 Rule Livewell / Baitwell Pumps & Systems



Keep your tournament-sized catches alive and fresh until you get back to shore. Outfit your fishing vessel's livewell and baitwell with efficient, sturdy, reliable Rule and Jabsco pumps and motors.

Rule Tournament Series Livewell Pumps

MODEL NO.	CAPACITY	DESCRIPTION
401C	500 GPH (1893 LPH)	Through-hull applications requiring an angled pickup tube, 4" (100mm) long straight thread
401STC	500 GPH (1893 LPH)	Through-hull applications requiring a straight pickup tube, 4-3/4" (121mm) long straight thread
401FC	500 GPH (1893 LPH)	Seacock-mounted applications requiring a 3/4" (19mm) NPT tapered thread
403C	800 GPH (3028 LPH)	Through-hull applications requiring an angled pickup tube, 4" (100mm) long straight thread
403STC	800 GPH (3028 LPH)	Through-hull applications requiring a straight pickup tube, 4-3/4" (121mm) long straight thread
403FC	800 GPH (3028 LPH)	Seacock-mounted applications requiring a 3/4" (19mm) NPT tapered thread
405C	1100 GPH (4164 LPH)	Through-hull applications requiring an angled pickup tube, 4" (100mm) long straight thread
405STC	1100 GPH (4164 LPH)	Through-hull applications requiring a straight pickup tube, 4-3/4" (121mm) long straight thread
405FC	1100 GPH (4164 LPH)	Seacock-mounted applications requiring a 3/4" (19mm) NPT tapered thread

Rule Tournament Series 1600 Livewell Pumps



Designed for the toughest applications, the 1600 GPH (6057 LPH) model is the highest capacity Livewell Pump on the market. It features a bronze base, an anti-airlock feature and a heavy-duty, long-life motor.

MODEL NO.	VOLTS (DC)
209B	12
209FDP	12, dual port

Rule General Purpose Centrifugal Pumps



Designed for washdown or to circulate water to livewell tanks, the General Purpose Pump features heavy-duty construction, making it ideal for commercial or pleasure boats. It has a 1-1/2" (38mm) inlet and 1-1/2" (38mm) discharge outlet with a maximum pumping capacity of 3700 GPH (14006 LPH). It must be mounted below the waterline; although it pumps a lot of water, it operates at low pressure and is not self-priming.

MODEL NO.	VOLTS (DC)
17A	12
18A	24

Rule Replacement Motor Modules



The innovative Tournament Series pumps feature these removable motor cartridges, which are fast and convenient to replace.

MODEL NO.	DESCRIPTION
45DR	500 replacement motor cartridge
46DR	800 replacement motor cartridge
47DR	1100 replacement motor cartridge

Jabsco Fish Box Evacuation Pump



This pump easily passes debris such as bait residue, fish scales and ice particles, which are often left in the box after a day of fishing.

MODEL NO.	VOLTS (DC)	DESCRIPTION
50900-1000	12	1" (25mm) and 1-1/2" (38mm) hose barb discharge
50900-1100	24	

Tips on Selecting a Livewell Pump

A general rule of thumb is to choose a pump that provides enough flow to exchange the water in the tank 6-10 times per hour. However, livewell systems have so many variables that it's hard to calculate flow accurately. Some factors to consider are:

- Head height
- Angles or elbows
- Fittings
- Spray nozzles
- Other restrictors in the system

The easiest way to check if you have enough flow is to mount a Series 500 Livewell Pump in the vessel, as low and close to the hull as possible, and have a Series 800 Livewell Pump cartridge on hand.

Starting with an empty tank, turn on the pump and time how long it takes to fill. If it takes between 6 and 10 minutes, it's good. If it takes less than 6 minutes, there's too much water flowing through the tank, which could damage the bait. Try using a valve to restrict the flow.

If it takes longer than 10 minutes, repeat the test with the Series 800 cartridge. The 500 and 800 GPH pumps use the same base assembly and plumbing, so there's no need to change the base. If the Series 800 still won't fill the tank in less than 10 minutes, you might need the Series 1100, or even the Series 1600.

However, note that bigger is not necessarily better. Too much pump capacity could create airlocks and damage delicate bait. Also, be careful with aggressive, high-speed water intake scoops. They can damage the pump.

20 Jabsco Engine Cooling Pumps & Replacement Impellers

Back in the 1930s, Californians Jack Briggs and Art Streeter developed the first-ever flexible impeller pump for use in air conditioning systems. That was the foundation of Jabsco (the Jack Art Briggs Streeter Company).

Business took off during the war years, when manufacturers discovered that the flexible impeller pump is perfect for cooling marine engines; it's self-priming, it offers the ability to handle solids in suspension like sand and silt, it's simple, it's highly reliable, and it's easy to maintain. Since then, marine engine manufacturers around the globe have relied on Jabsco pumps.

Jabsco impellers are subjected to rigorous quality processes to ensure reliable, efficient and long-lasting performance. The impeller is the one working part of an engine cooling pump that should be replaced annually. Your local stockist can help identify the correct replacement for full reliability.

Impeller Replacement



Replace all impellers every year or sooner, and always carry a spare on board in case of damage. Replacing impellers is easy.

First and most importantly, close the inlet seacock of your engine's cooling system. Next, remove the end cover screws from the pump (being careful not to drop them in the bilge), then remove the end cover. Note the way the impeller blades are slanting; you will need to install the new impeller the same way.

Now remove the impeller using an impeller removal tool, or by using pliers to grip the hub of the impeller. Don't use screwdrivers, as they can damage the face of the pump and cause leaks, which may be dangerous in confined spaces.

Always grease new impellers; this makes them easier to install and gives added protection to the impeller during the initial prime. Be sure to replace the seal between the end cover and the pump body before refitting the end cover. We offer impeller kits with a variety of replacement gaskets to simplify the job.

Jabsco Flexible Impeller Removal Tools



Using this tool is the easiest way to remove an impeller, especially when the pump is mounted in a cramped space.

MODEL NO.	DESCRIPTION
50070-0080	Compact version suitable for impellers up to 2-1/4" (57mm)
50070-0040	Suitable for impellers up to 2-1/2" (65mm) diameter
50070-0200	Suitable for impellers from 2-1/2" (65mm) to 4-1/2" (118mm) diameter

21 Heavy-Duty Radial Blowers, Radial & In-Line Blowers, Inflators

Boating isn't only about water; it's about air too. Ensure that your vessel is properly ventilated and your inflatables are fully inflated. Install only top-quality blowers and inflators from Rule and Jabsco.

Rule In-line Blowers



Designed for efficient, high-output operation, these blowers provide ventilation for bilges, engine compartments, galleys and heads. They feature exclusive front and rear shaft seals, corrosion-resistant motors and premium-quality electrical connections for long life.

MODEL	DUCTING (IN/MM)	VOLTS (DC)	FUSE SIZE (AMPS)
140	3" (76mm)	12	4.0
140-24V	3" (76mm)	24	2.5
240	4" (102mm)	12	4
240-24V	4" (102mm)	24	2.5

Jabsco Heavy Duty Flangemount and Flexmount Blowers



Available in either Flange or Flexmount form, these powerful blowers are designed for use wherever continuous ventilation is required. A motor life of 5,000 hours is guaranteed for service in the toughest conditions. They provide outputs of 250 cfm (7.1m³/min).

MODEL NO.	DESCRIPTION
35760-0092	12V DC, flangemount
35760-0094	24V DC, flangemount
35770-0092	12V DC, flexmount
35770-0094	24V DC, flexmount

Jabsco Flangemount and Flexmount Blowers



35115 Series



35400 Series



35440 Series



34739 Series

These quiet-running blowers are designed to allow easy connection to ductwork. They incorporate corrosion-resistant materials throughout. Three sizes are available, with outputs of 105 cfm (3m³/min) (12V only), 150 cfm (4.2m³/min) (12 and 24V) and 250 cfm (7.1m³/min) (12 and 24V).

FLEXMOUNT

MODEL NO.	DESCRIPTION
35115-0010	3m ³ /min output, 12V DC
36740-0000	4.2m ³ /min output, 12V DC
36740-0010	4.2m ³ /min output, 24V DC
35440-0000	7.1m ³ /min output, 12V DC
35440-0010	7.1m ³ /min output, 24V DC

FLANGEMOUNT

MODEL NO.	DESCRIPTION
35115-0020	3m ³ /min output, 12V DC
34739-0010	4.2m ³ /min output, 12V DC
34739-0020	4.2m ³ /min output, 24V DC
35400-0000	7.1m ³ /min output, 12V DC
35400-0010	7.1m ³ /min output, 24V DC

Rule High Speed Inflator/Deflator



This super-fast air pump cuts the inflation time for a typical four-man dinghy to less than two minutes. Powered by a standard 12V boat or car battery, it comes with a range of adjustable nozzles to fit plastic, rubber, and sprung valves on all major brands.

MODEL NO.	DESCRIPTION
iD20	12V DC, inflator/deflator
iD20K	Replacement nozzle kit

22 Jabsco Remote Control Kits & Harnesses, Floodlights

See what's at sea or on deck when you're boating at night. Xylem offers a range of bright, long-lasting products, including remote control searchlights, bracket-mounted floodlights and wiring harnesses.

Jabsco 135 SL RC Searchlights



Developed with the smaller boat in mind, the 5" by 3" halogen-sealed beam delivers 100,000 candlepower, providing 1 lux at 885' (262m). The 135 SL rotates 320 degrees horizontally and 75 degrees vertically.

MODEL NO.	VOLTS (DC)
60020-0000	12
60020-0024	24

Jabsco 146 SL RC Searchlights



The 175,000 candlepower, 6" by 4" halogen-sealed beam brings long-range capability to mid-sized boats, producing 1 lux at 1275' (386m). Offering 360 degrees vertical rotation, the 146 SL gives high performance at a reasonable cost. An optional dual station control kit is available.

MODEL NO.	VOLTS (DC)
60080-0012	12
60080-0024	24

Jabsco 155 (5") SL RC Searchlights



The watertight, halogen-sealed beam will pick out hazards at nearly 900' (275m) by producing 1 lux at 885' (268m) with 100,000 candlepower. Offering style, performance and value, the 155 SL has sweeping curves and fingertip controls.

MODEL NO.	VOLTS (DC)
61050-0012	12
61050-1224	12/24 (with electronic control)

Jabsco 180 (7") RC Searchlights



The 180mm model produces a mighty 230,000 candlepower and 1 lux at 1380' (418m). Made of heavily chromed brass for a classic look, it comes complete with a water-resistant, dual-speed control panel.

MODEL NO.	VOLTS (DC)
62040-4002	12
62040-4006	24

Jabsco 200 (8") RC Searchlight



The most powerful remote control light that Jabsco manufactures is the 200mm model, which produces a huge 500,000 candlepower output with 1 lux at 2375' (719m). Equipped with a water-resistant, dual-speed control panel, it's made of heavily chromed brass, giving it a classic appearance.

MODEL NO.	VOLTS (DC)
62042-4006	24



23 Lighting Accessories

Jabsco Secondary Remote Control Kits



These kits are the only way to achieve dual station control of Jabsco remote control searchlights.

MODEL NO.	DESCRIPTION
43670-0004	For 130 (12V), 180 (12V), 146SL (12V or 24V), 255SL (12V)
18753-0335	For 180 (24V), 200 (24V), 255SL (24V)
64044-0000	For 155SL (electronic 12/24V), 156SL (electronic 24V), 150 (electronic 12/24V)
43670-0005	Dual station installation kit

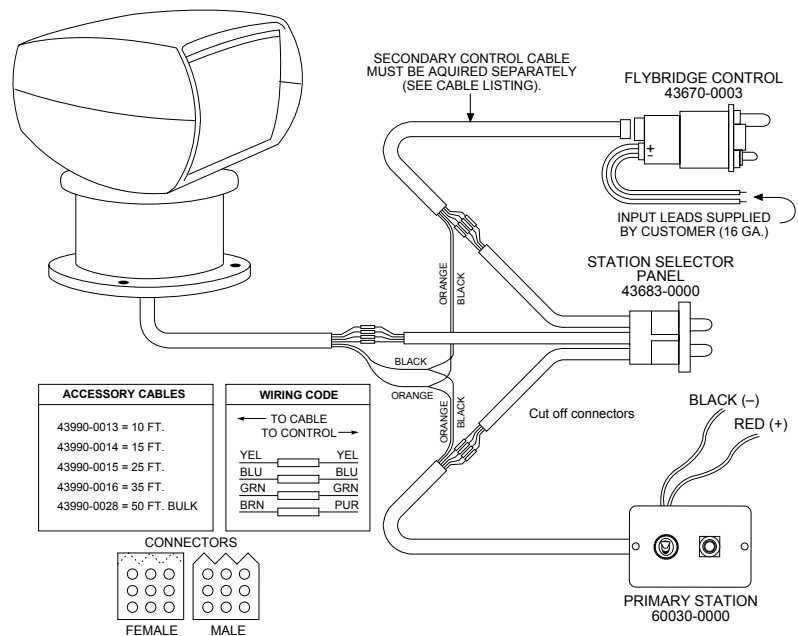

Jabsco Extension Harnesses



These wiring harnesses allow for remote control installations where cable lengths are greater than those supplied with the light.

MODEL NO.	DESCRIPTION
43990-0013	10' (3m) standard control
43990-0014	15' (4.5m) standard control
43990-0015	25' (7.6m) standard control
43990-0016	50' (15.2m) standard control
64042-1011	10' (3m) electronic control
64042-1007	15' (4.5m) electronic control
64042-1008	25' (7.6m) electronic control
64042-1009	50' (15.2m) electronic control

Jabsco Deck Floodlights



This range of compact floodlights for the deck, cockpit, or boarding point comes available in two sizes: 3" by 5" and 4" by 6"

3" X 5"

MODEL NO.	DESCRIPTION
45900-1000	12V DC, white
45903-0002	Replacement sealed beam
45900-3000	12V DC, black

4" X 6"

MODEL NO.	DESCRIPTION
45900-4000	12V DC, ultra bright white (not available in Europe)
45900-0000	12V DC, white
45900-0001	24V DC, white
45903-0000	50 watt replacement bulb
45903-0001	70 watt replacement bulb



MECTRA SYNERGY (M) SDN BHD

B-G-31 MENARA PRIMA, JALAN PJU 1/39 DATARAN PRIMA, 47301 PETALING JAYA, SELANGOR
TEL : +603 7886 1732 | EMAIL : sales@mectra.com.my | WEBSITE : www.mectra.com.my